

ASSEMBLY INSTRUCTIONS

MODEL: 58111

Before assembly, please remove all parts from the carton, verifying that you have the correct quantities, and read all the instructions.

Ax1	Hx3
Bx1	Jx3
Cx1+1	Kx3
Dx1	Lx4
Ex1	Mx2
Fx5	M6x35
Gx1	
M6	

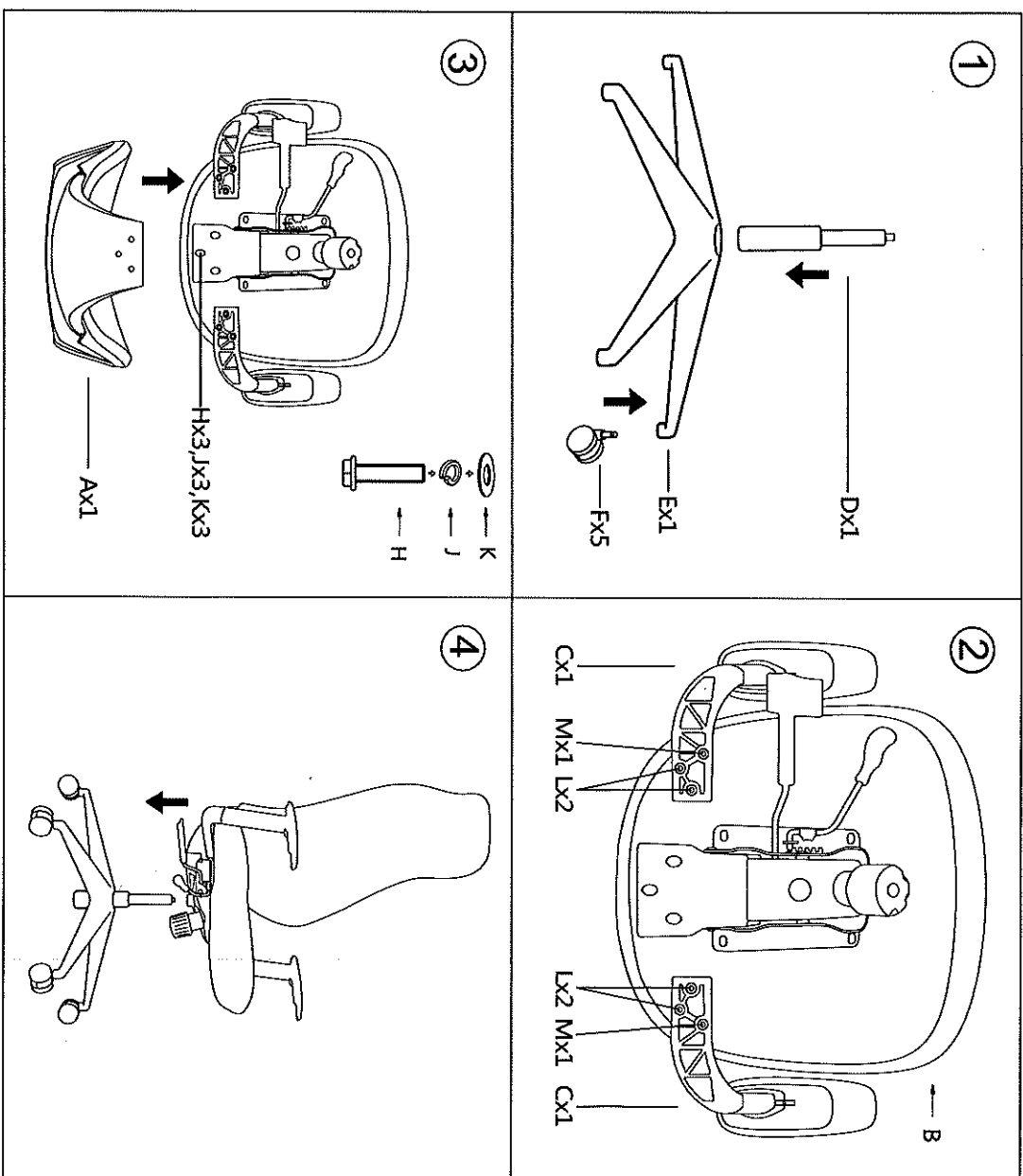

ATTENTION

Do not tighten any screws or bolts until the unit is completely assembled.
Ensure all bolts and screws are tightened before using, check bolts and screws every 6 months.
If any parts are missing, broken, damaged or worn, stop use of product until repairs have been made using factory authorized parts.
Failure to follow these warnings may result in injury.